

Key

| | | | | | | | | | |
|--|--------------------------|----------------------------|---------------------------------|---------------------------------|--------------------------|---------------------------------|---------------------------------|---------------------------------|-------------------------------|
| 01A ADVANCED WARNING ACCESS TO ROAD AHEAD CLOSED ON ____ TO ____ FOR ____ DAY(S) FROM ____ TO ____ | 01 ROAD CLOSED | 02 Diverion ENDS | 04 Diverted traffic → | 06 Diverted traffic ↑ | 08 Diversion ← | 10 ROAD AHEAD CLOSED | 12 Diverted traffic ↻ | 14 Diverted traffic ↻ | 15 NO THROUGH ROUTE |
| | | 03 Diverion ENDS | 05 Diverted traffic ← | 07 Diversion → | 09 Diversion ↑ | 11 Diverted traffic ↻ | 13 Diverted traffic ↻ | | |

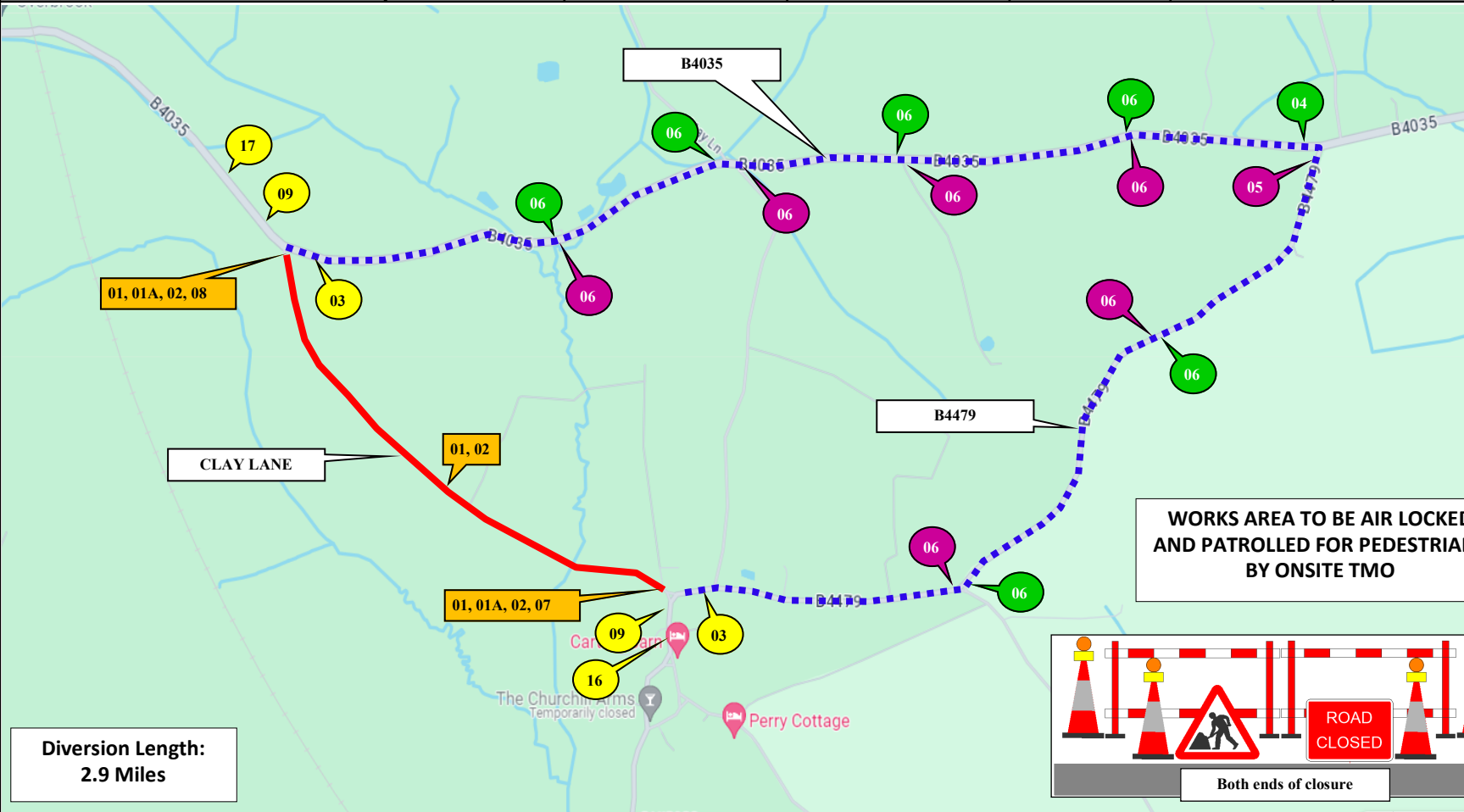

16 ROAD AHEAD CLOSED

17 ROAD AHEAD CLOSED

20 CYCLISTS AND PEDESTRIANS WAIT HERE TO BE ESCORTED

RADIOS REQUIRED
TM to Provide
Openreach Engineer
With Radio.

Diversion Length:
2.9 Miles

SUNBELT RENTALS

Sunbelt Rentals UK (Traffic Management)
Kemble Airfield Enterprise Park
Cirencester Road
Kemble
GL7 6BQ
☎ 03700 500 792
📠 0845 004 7105

Note

- All equipment shall be approved and shall comply with the Department Of Transport specification MCE0111. This drawing does not show the normal road works signage that will be required as per Chapter 8.
- All signs to be in accordance with TSRGD 2016 and to minimum class retroreflective.
- Minimum height of lettering to be 60mm and sign boards to be 1000mm (750mm where appropriate). This drawing is protected by copyright and the information contained therein is confidential. This drawing may not be copied and the information therein may not be used, or disclosed to a third party, wholly or in part with the written permission of Sunbelt Rentals UK (Traffic Management).

CROWN COPYRIGHT DATA REPRODUCED BY PERMISSION OF THE CONTROLLER OF HMSO

| | | | | |
|---|---------------------------|------------------------------|---------------------------|---|
| CLIENT DETAILS OPENREACH | | REP/DEPOT NB/213 | DRAWN BY NB/213 | ADDRESS Clay Lane, Blockley, Paxford, Gloucestershire, GL55 6FD |
| DATE 29/12/2023 | SHEET No 1 OF 1 | VERSION NUMBER 001 | | |
| AMENDED DATE | AMENDED BY | SCALE NOT TO SCALE | | |
| This layout is for installation by NRSWA, Lantra 12A,12B,12D qualified persons. | | | | |
| BUS ROUTE AFFECTED | | | | |

| | | | |
|-------------------------------------|--------------|--------------------|--------------------------|
| | ROAD CLOSURE | | CLOCKWISE DIVERSION |
| | DIVERSION | | ANTI-CLOCKWISE DIVERSION |
| | | | ROAD CLOSURE SIGN |
| ROAD CLOSURE LENGTH (APPROX) | | 1280 M | |
| ROAD CLOSURE WIDTH (APPROX) | | 3.0 M | |
| Contract Number | | 213-S014741 | |